

BS EN 1092-1 PN 10

$\varnothing ID$		$\varnothing OD$		$\varnothing PCD$		Tf		$\varnothing d$		$\varnothing RF$		Rf		Number of holes
DN	NPS	mm	inch	mm	inch	mm	inch	mm	inch	mm	inch	mm	inch	
15	½	95	3.74	65.00	2.56	16.00	0.63	14.00	0.55	45	1.77	2	0.08	4
20	¾	105	4.13	75.00	2.95	18.00	0.71	14.00	0.55	58	2.28	2	0.08	4
25	1	115	4.53	85.00	3.35	18.00	0.71	14.00	0.55	68	2.68	2	0.08	4
32	1¼	140	5.51	100.00	3.94	18.00	0.71	18.00	0.71	78	3.07	2	0.08	4
40	1½	150	5.91	110.00	4.33	18.00	0.71	18.00	0.71	88	3.46	3	0.12	4
50	2	165	6.50	125.00	4.92	18.00	0.71	18.00	0.71	102	4.02	3	0.12	4
65	2½	185	7.28	145.00	5.71	18.00	0.71	18.00	0.71	122	4.80	3	0.12	8
80	3	200	7.87	160.00	6.30	20.00	0.79	18.00	0.71	138	5.43	3	0.12	8
100	4	220	8.66	180.00	7.09	20.00	0.79	18.00	0.71	158	6.22	3	0.12	8
125	5	250	9.84	210.00	8.27	22.00	0.87	18.00	0.71	188	7.40	3	0.12	8
150	6	285	11.22	240.00	9.45	22.00	0.87	22.00	0.87	212	8.35	3	0.12	8
200	8	340	13.39	295.00	11.61	24.00	0.94	22.00	0.87	268	10.55	3	0.12	8
250	10	395	15.55	350.00	13.78	26.00	1.02	22.00	0.87	320	12.60	3	0.12	12
300	12	445	17.52	400.00	15.75	26.00	1.02	22.00	0.87	370	14.57	4	0.16	12
350	14	505	19.88	460.00	18.11	26.00	1.02	22.00	0.87	430	16.93	4	0.16	16
400	16	565	22.24	515.00	20.28	26.00	1.02	26.00	1.02	482	18.98	4	0.16	16
450	18	615	24.21	565.00	22.24	28.00	1.10	26.00	1.02	532	20.94	4	0.16	20
500	20	670	26.38	620.00	24.41	28.00	1.10	26.00	1.02	585	23.03	4	0.16	20
600	24	780	30.71	725.00	28.54	34.00	1.34	30.00	1.02	685	26.97	5	0.20	20

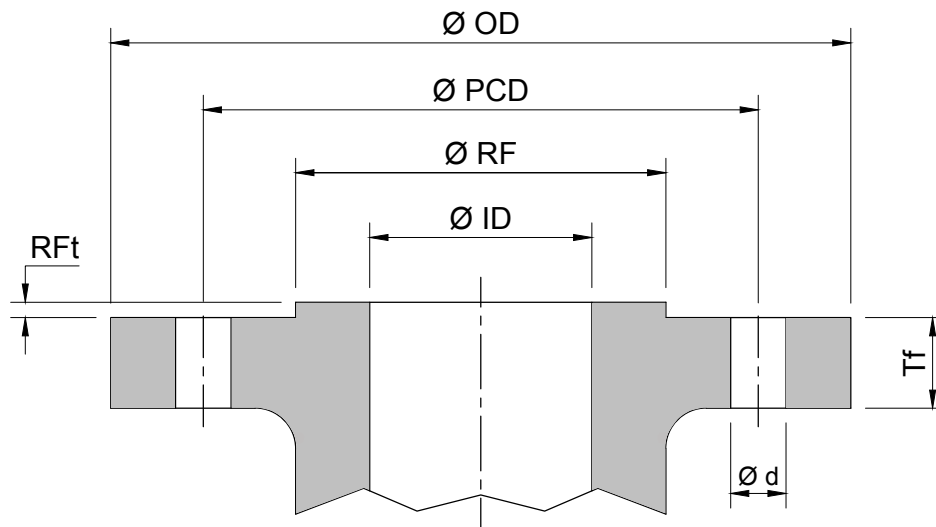

BS EN 1092-1 PN 16

$\varnothing ID$		$\varnothing OD$		$\varnothing PCD$		Tf		$\varnothing d$		$\varnothing RF$		Rf		Number of holes
DN	NPS	mm	inch	mm	inch	mm	inch	mm	inch	mm	inch	mm	inch	
15	½	95	3.74	65.00	2.56	16.00	0.63	14.00	0.55	45	1.77	2	0.08	4
20	¾	105	4.13	75.00	2.95	18.00	0.71	14.00	0.55	58	2.28	2	0.08	4
25	1	115	4.53	85.00	3.35	18.00	0.71	14.00	0.55	68	2.68	2	0.08	4
32	1¼	140	5.51	100.00	3.94	18.00	0.71	18.00	0.71	78	3.07	2	0.08	4
40	1½	150	5.91	110.00	4.33	18.00	0.71	18.00	0.71	88	3.46	3	0.12	4
50	2	165	6.50	125.00	4.92	18.00	0.71	18.00	0.71	102	4.02	3	0.12	4
65	2½	185	7.28	145.00	5.71	18.00	0.71	18.00	0.71	122	4.80	3	0.12	8
80	3	200	7.87	160.00	6.30	20.00	0.79	18.00	0.71	138	5.43	3	0.12	8
100	4	220	8.66	180.00	7.09	20.00	0.79	18.00	0.71	158	6.22	3	0.12	8
125	5	250	9.84	210.00	8.27	22.00	0.87	18.00	0.71	188	7.40	3	0.12	8
150	6	285	11.22	240.00	9.45	22.00	0.87	22.00	0.87	212	8.35	3	0.12	8
200	8	340	13.39	295.00	11.61	24.00	0.94	26.00	1.02	268	10.55	3	0.12	12
250	10	405	15.94	350.00	13.78	26.00	1.02	26.00	1.02	320	12.60	3	0.12	12
300	12	460	18.11	400.00	15.75	28.00	1.10	26.00	1.02	378	14.88	4	0.16	12
350	14	520	20.47	460.00	18.11	30.00	1.18	26.00	1.02	438	17.24	4	0.16	16
400	16	580	22.83	515.00	20.28	32.00	1.26	30.00	1.18	490	19.29	4	0.16	16
450	18	640	25.20	565.00	22.24	40.00	1.57	30.00	1.18	550	21.65	4	0.16	20
500	20	715	28.15	620.00	24.41	44.00	1.73	33.00	1.30	610	24.02	4	0.16	20
600	24	840	33.07	725.00	28.54	54.00	2.13	36.00	1.42	725	28.54	5	0.20	20



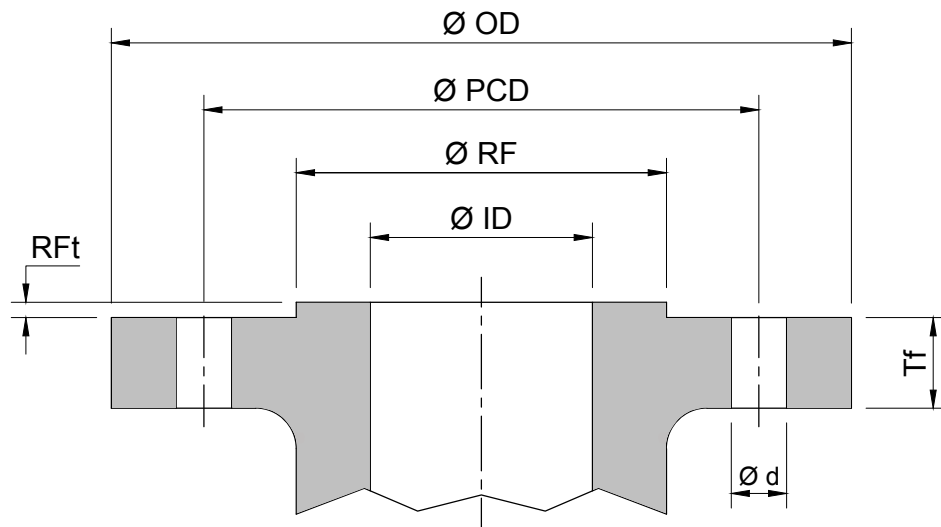

BS EN 1092-1 PN 25

$\varnothing ID$		$\varnothing OD$		$\varnothing PCD$		Tf		$\varnothing d$		$\varnothing RF$		Rf		Number of holes
DN	NPS	mm	inch	mm	inch	mm	inch	mm	inch	mm	inch	mm	inch	
15	½	95	3.74	65.00	2.56	16.00	0.63	14.00	0.55	45	1.77	2	0.08	4
20	¾	105	4.13	75.00	2.95	18.00	0.71	14.00	0.55	58	2.28	2	0.08	4
25	1	115	4.53	85.00	3.35	18.00	0.71	14.00	0.55	68	2.68	2	0.08	4
32	1¼	140	5.51	100.00	3.94	18.00	0.71	18.00	0.71	78	3.07	2	0.08	4
40	1½	150	5.91	110.00	4.33	18.00	0.71	18.00	0.71	88	3.46	3	0.12	4
50	2	165	6.50	125.00	4.92	20.00	0.79	18.00	0.71	102	4.02	3	0.12	4
65	2½	185	7.28	145.00	5.71	22.00	0.87	18.00	0.71	122	4.80	3	0.12	8
80	3	200	7.87	160.00	6.30	24.00	0.94	18.00	0.71	138	5.43	3	0.12	8
100	4	235	9.25	190.00	7.48	24.00	0.94	22.00	0.87	162	6.38	3	0.12	8
125	5	270	10.63	220.00	8.66	26.00	1.02	26.00	1.02	188	7.40	3	0.12	8
150	6	300	11.81	250.00	9.84	28.00	1.10	26.00	1.02	218	8.58	3	0.12	8
200	8	360	14.17	310.00	12.20	30.00	1.18	26.00	1.02	278	10.94	3	0.12	12
250	10	425	16.73	370.00	14.57	32.00	1.26	30.00	1.18	335	13.19	3	0.12	12
300	12	485	19.09	430.00	16.93	34.00	1.34	30.00	1.18	395	15.55	4	0.16	16
350	14	555	21.85	490.00	19.29	38.00	1.50	33.00	1.30	450	17.72	4	0.16	16
400	16	620	24.41	550.00	21.65	40.00	1.57	36.00	1.42	505	19.88	4	0.16	16
450	18	670	26.38	600.00	23.62	46.00	1.81	36.00	1.42	555	21.85	4	0.16	20
500	20	730	28.74	660.00	25.98	48.00	1.89	36.00	1.42	615	24.21	4	0.16	20
600	24	845	33.27	770.00	30.31	58.00	2.28	39.00	1.54	720	28.35	5	0.20	20

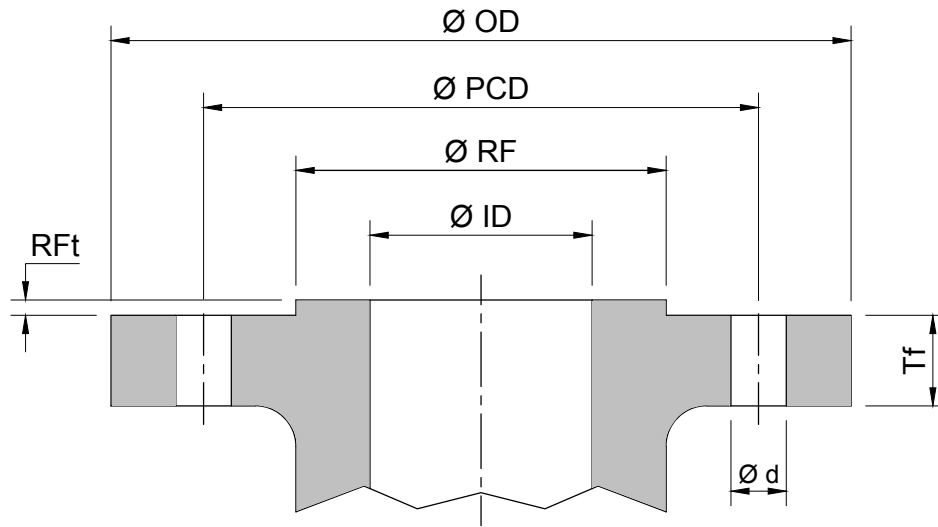

BS EN 1092-1 PN 40

$\varnothing ID$		$\varnothing OD$		$\varnothing PCD$		Tf		$\varnothing d$		$\varnothing RF$		Rf		Number of holes
DN	NPS	mm	inch	mm	inch	mm	inch	mm	inch	mm	inch	mm	inch	
15	½	95	3.74	65.00	2.56	16.00	0.63	14.00	0.55	45	1.77	2	0.08	4
20	¾	105	4.13	75.00	2.95	18.00	0.71	14.00	0.55	58	2.28	2	0.08	4
25	1	115	4.53	85.00	3.35	18.00	0.71	14.00	0.55	68	2.68	2	0.08	4
32	1¼	140	5.51	100.00	3.94	18.00	0.71	18.00	0.71	78	3.07	2	0.08	4
40	1½	150	5.91	110.00	4.33	18.00	0.71	18.00	0.71	88	3.46	3	0.12	4
50	2	165	6.50	125.00	4.92	20.00	0.79	18.00	0.71	102	4.02	3	0.12	4
65	2½	185	7.28	145.00	5.71	22.00	0.87	18.00	0.71	122	4.80	3	0.12	8
80	3	200	7.87	160.00	6.30	24.00	0.94	18.00	0.71	138	5.43	3	0.12	8
100	4	235	9.25	190.00	7.48	24.00	0.94	22.00	0.87	162	6.38	3	0.12	8
125	5	270	10.63	220.00	8.66	26.00	1.02	26.00	1.02	188	7.40	3	0.12	8
150	6	300	11.81	250.00	9.84	28.00	1.10	26.00	1.02	218	8.58	3	0.12	8
200	8	375	14.76	320.00	12.60	34.00	1.34	30.00	1.18	285	11.22	3	0.12	12
250	10	450	17.72	385.00	15.16	38.00	1.50	33.00	1.30	345	13.58	3	0.12	12
300	12	515	20.28	450.00	17.72	42.00	1.65	33.00	1.30	410	16.14	4	0.16	16
350	14	580	22.83	510.00	20.08	46.00	1.81	36.00	1.42	465	18.31	4	0.16	16
400	16	660	25.98	585.00	23.03	50.00	1.97	39.00	1.54	535	21.06	4	0.16	16
450	18	685	26.97	610.00	24.02	57.00	2.24	39.00	1.54	560	22.05	4	0.16	20
500	20	755	29.72	670.00	26.38	57.00	2.24	42.00	1.65	615	24.21	4	0.16	20
600	24	890	35.04	795.00	31.30	72.00	2.83	48.00	1.89	735	28.94	5	0.20	20



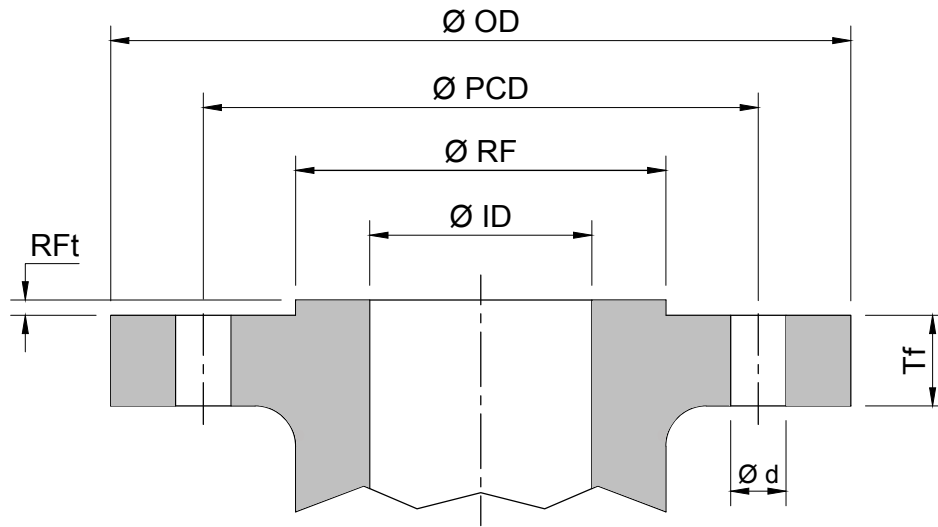

BS EN 1092-1 PN 63

ØID		ØOD		ØPCD		Tf		Ød		ØRF		Rf		Number of holes
DN	NPS	mm	inch	mm	inch	mm	inch	mm	inch	mm	inch	mm	inch	
	½	105	4.13	75.00	2.95	20.00	0.79	14.00	0.55	45	1.77	2	0.08	4
20	¾	130	5.12	90.00	3.54	22.00	0.87	18.00	0.71	58	2.28	2	0.08	4
25	1	140	5.51	100.00	3.94	24.00	0.94	18.00	0.71	68	2.68	2	0.08	4
32	1¼	155	6.10	110.00	4.33	26.00	1.02	22.00	0.87	78	3.07	2	0.08	4
40	1½	170	6.69	125.00	4.92	28.00	1.10	22.00	0.87	88	3.46	3	0.12	4
50	2	180	7.09	135.00	5.31	26.00	1.02	22.00	0.87	102	4.02	3	0.12	4
65	2½	205	8.07	160.00	6.30	26.00	1.02	22.00	0.87	122	4.80	3	0.12	8
80	3	215	8.46	170.00	6.69	28.00	1.10	22.00	0.87	138	5.43	3	0.12	8
100	4	250	9.84	200.00	7.87	30.00	1.18	26.00	1.02	162	6.38	3	0.12	8
125	5	295	11.61	240.00	9.45	34.00	1.34	30.00	1.18	188	7.40	3	0.12	8
150	6	345	13.58	280.00	11.02	36.00	1.42	33.00	1.30	218	8.58	3	0.12	8
200	8	415	16.34	345.00	13.58	42.00	1.65	36.00	1.42	285	11.22	3	0.12	12
250	10	470	18.50	400.00	15.75	46.00	1.81	36.00	1.42	345	13.58	3	0.12	12
300	12	530	20.87	460.00	18.11	52.00	2.05	36.00	1.42	410	16.14	4	0.16	16
350	14	600	23.62	525.00	20.67	56.00	2.20	39.00	1.54	465	18.31	4	0.16	16
400	16	670	26.38	585.00	23.03	60.00	2.36	42.00	1.65	535	21.06	4	0.16	16

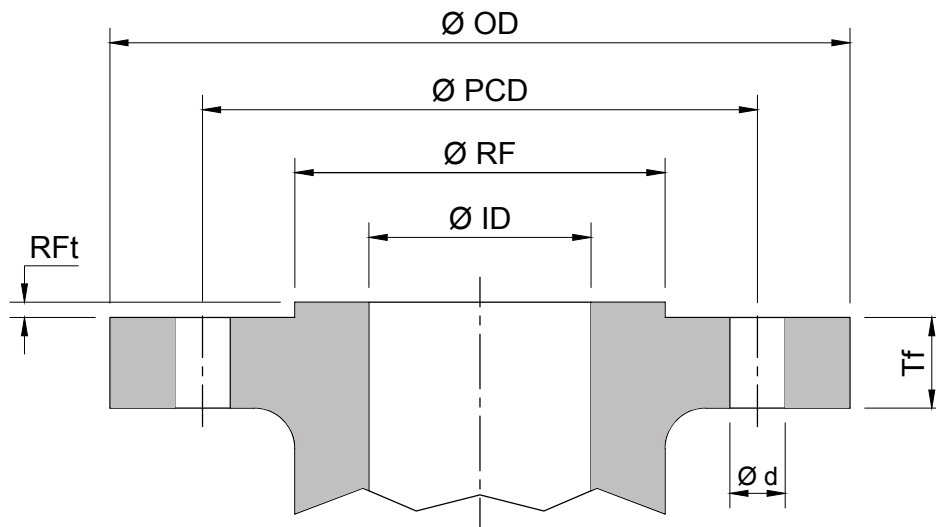

BS EN 1092-1 PN 100

$\varnothing ID$		$\varnothing OD$		$\varnothing PCD$		Tf		$\varnothing d$		$\varnothing RF$		Rf		Number of holes
DN	NPS	mm	inch	mm	inch	mm	inch	mm	inch	mm	inch	mm	inch	
15	½	105	4.13	75.00	2.95	20.00	0.79	14.00	0.55	45	1.77	2	0.08	4
20	¾	130	5.12	90.00	3.54	22.00	0.87	18.00	0.71	58	2.28	2	0.08	4
25	1	140	5.51	100.00	3.94	24.00	0.94	18.00	0.71	68	2.68	2	0.08	4
32	1¼	155	6.10	110.00	4.33	26.00	1.02	22.00	0.87	78	3.07	2	0.08	4
40	1½	170	6.69	125.00	4.92	28.00	1.10	22.00	0.87	88	3.46	3	0.12	4
50	2	195	7.68	145.00	5.71	30.00	1.18	26.00	1.02	102	4.02	3	0.12	4
65	2½	220	8.66	170.00	6.69	34.00	1.34	26.00	1.02	122	4.80	3	0.12	8
80	3	230	9.06	180.00	7.09	36.00	1.42	26.00	1.02	138	5.43	3	0.12	8
100	4	265	10.43	210.00	8.27	40.00	1.57	30.00	1.18	162	6.38	3	0.12	8
125	5	315	12.40	250.00	9.84	40.00	1.57	33.00	1.30	188	7.40	3	0.12	8
150	6	355	13.98	290.00	11.42	44.00	1.73	33.00	1.30	218	8.58	3	0.12	12
200	8	430	16.93	360.00	14.17	52.00	2.05	36.00	1.42	285	11.22	3	0.12	12
250	10	505	19.88	430.00	16.93	60.00	2.36	39.00	1.54	345	13.58	3	0.12	12
300	12	585	23.03	500.00	19.69	68.00	2.68	42.00	1.65	410	16.14	4	0.16	16
350	14	655	25.79	560.00	22.05	74.00	2.91	48.00	1.89	465	18.31	4	0.16	16



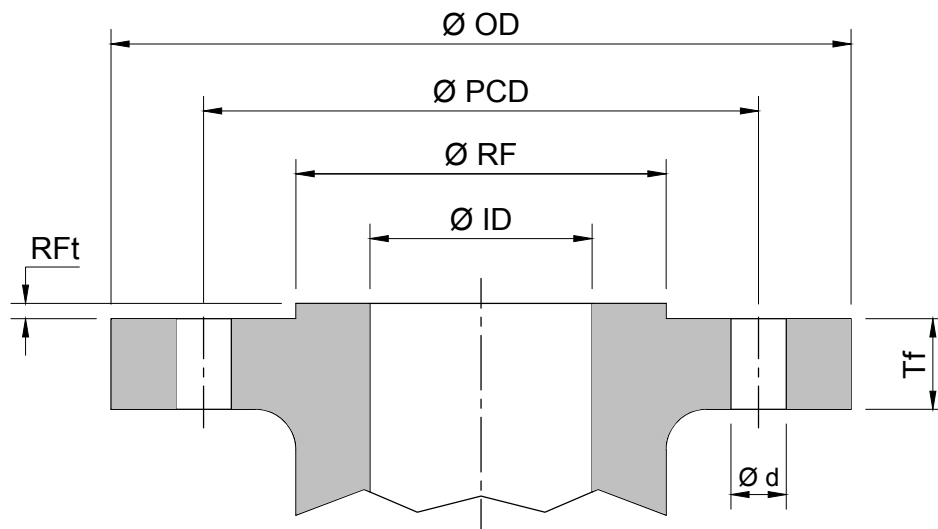

BS EN 1092-1 PN 160

ØID		ØOD		ØPCD		Tf		Ød		ØRF		Rf		Number of holes
DN	NPS	mm	inch	mm	inch	mm	inch	mm	inch	mm	inch	mm	inch	
15	½	105	4.13	75.00	2.95	20.00	0.79	14.00	0.55	45	1.77	2	0.08	4
25	1	140	5.51	100.00	3.94	24.00	0.94	18.00	0.71	68	2.68	2	0.08	4
40	1½	170	6.69	125.00	4.92	28.00	1.10	22.00	0.87	88	3.46	3	0.12	4
50	2	195	7.68	145.00	5.71	30.00	1.18	26.00	1.02	102	4.02	3	0.12	4
65	2½	220	8.66	170.00	6.69	34.00	1.34	26.00	1.02	122	4.80	3	0.12	8
80	3	230	9.06	180.00	7.09	36.00	1.42	26.00	1.02	138	5.43	3	0.12	8
100	4	265	10.43	210.00	8.27	40.00	1.57	30.00	1.18	162	6.38	3	0.12	8
125	5	315	12.40	250.00	9.84	44.00	1.73	33.00	1.30	188	7.40	3	0.12	8
150	6	355	13.98	290.00	11.42	50.00	1.97	33.00	1.30	218	8.58	3	0.12	12
200	8	430	16.93	360.00	14.17	60.00	2.36	36.00	1.42	285	11.22	3	0.12	12
250	10	515	20.28	430.00	16.93	68.00	2.68	42.00	1.65	345	13.58	3	0.12	12
300	12	585	23.03	500.00	19.69	78.00	3.07	42.00	1.65	410	16.14	4	0.16	16

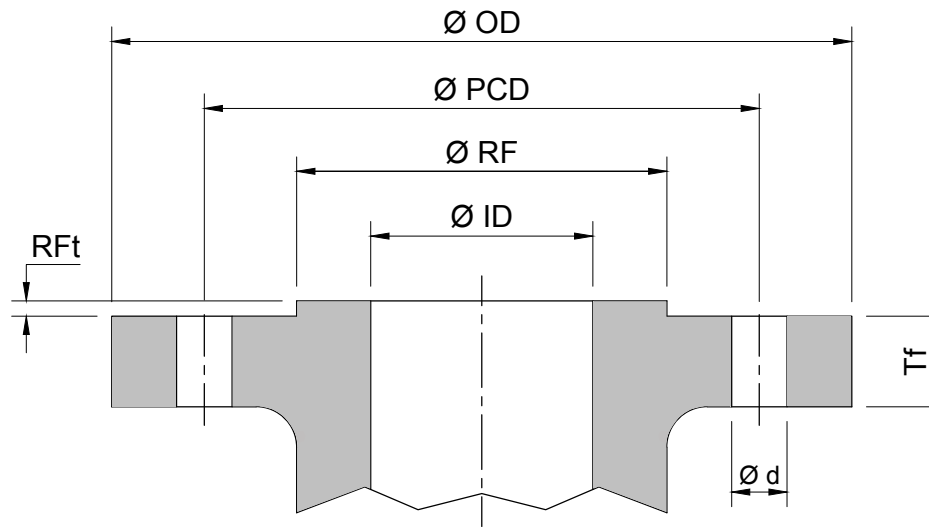

BS EN 1092-1 PN 250

$\varnothing ID$		$\varnothing OD$		$\varnothing PCD$		Tf		$\varnothing d$		$\varnothing RF$		Rf		Number of holes
DN	NPS	mm	inch	mm	inch	mm	inch	mm	inch	mm	inch	mm	inch	
15	½	105	4.13	75.00	2.95	20.00	0.79	14.00	0.55	45	1.77	2	0.08	4
20	¾	130	5.12	90.00	3.54	22.00	0.87	18.00	0.71	58	2.28	2	0.08	4
25	1	140	5.51	100.00	3.94	24.00	0.94	18.00	0.71	68	2.68	2	0.08	4
32	1¼	155	6.10	110.00	4.33	26.00	1.02	22.00	0.87	78	3.07	2	0.08	4
40	1½	170	6.69	125.00	4.92	28.00	1.10	22.00	0.87	88	3.46	3	0.12	4
50	2	195	7.68	145.00	5.71	30.00	1.18	26.00	1.02	102	4.02	3	0.12	4
65	2½	220	8.66	170.00	6.69	34.00	1.34	26.00	1.02	122	4.80	3	0.12	8
80	3	230	9.06	180.00	7.09	36.00	1.42	26.00	1.02	138	5.43	3	0.12	8
100	4	265	10.43	210.00	8.27	40.00	1.57	30.00	1.18	162	6.38	3	0.12	8
125	5	315	12.40	250.00	9.84	40.00	1.57	33.00	1.30	188	7.40	3	0.12	8
150	6	355	13.98	290.00	11.42	44.00	1.73	33.00	1.30	218	8.58	3	0.12	12
200	8	430	16.93	360.00	14.17	52.00	2.05	36.00	1.42	285	11.22	3	0.12	12
250	10	505	19.88	430.00	16.93	60.00	2.36	39.00	1.54	345	13.58	3	0.12	12
300	12	585	23.03	500.00	19.69	68.00	2.68	42.00	1.65	410	16.14	4	0.16	16
350	14	655	25.79	560.00	22.05	74.00	2.91	48.00	1.89	465	18.31	4	0.16	16



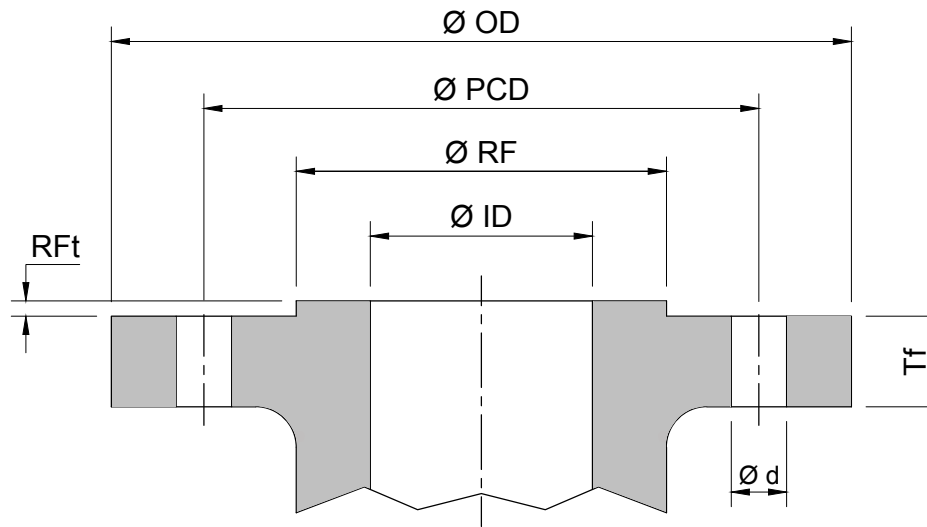

BS EN 1092-1 PN 320

ØID		ØOD		ØPCD		Tf		Ød		ØRF		Rf		Number of holes
DN	NPS	mm	inch	mm	inch	mm	inch	mm	inch	mm	inch	mm	inch	
15	½	130	5.12	90.00	3.54	26.00	1.02	18.00	0.71	45	1.77	2	0.08	4
25	1	160	6.30	115.00	4.53	34.00	1.34	22.00	0.87	68	2.68	2	0.08	4
40	1½	195	7.68	145.00	5.71	38.00	1.50	26.00	1.02	88	3.46	3	0.12	4
50	2	210	8.27	160.00	6.30	42.00	1.65	26.00	1.02	102	4.02	3	0.12	8
65	2½	255	10.04	200.00	7.87	51.00	2.01	30.00	1.18	122	4.80	3	0.12	8
80	3	275	10.83	220.00	8.66	55.00	2.17	30.00	1.18	138	5.43	3	0.12	8
100	4	335	13.19	265.00	10.43	65.00	2.56	36.00	1.42	162	6.38	3	0.12	8
125	5	380	14.96	310.00	12.20	75.00	2.95	36.00	1.42	188	7.40	3	0.12	12
150	6	425	16.73	350.00	13.78	84.00	3.31	39.00	1.54	218	8.58	3	0.12	12
200	8	525	20.67	440.00	17.32	103.00	4.06	42.00	1.65	285	11.22	3	0.12	16
250	10	640	25.20	540.00	21.26	125.00	4.92	52.00	2.05	345	13.58	3	0.12	16

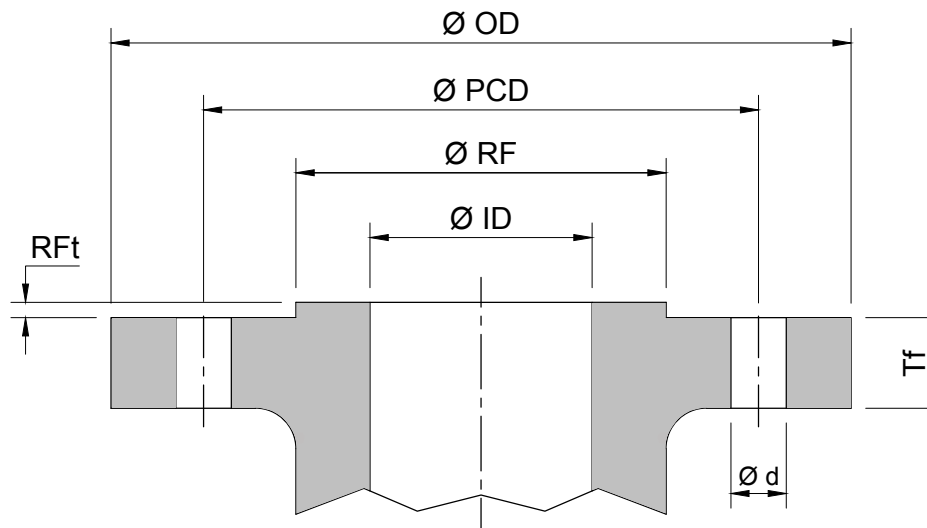

BS EN 1092-1 PN 400

$\varnothing ID$		$\varnothing OD$		$\varnothing PCD$		Tf		$\varnothing d$		$\varnothing RF$		Rf		Number of holes
DN	NPS	mm	inch	mm	inch	mm	inch	mm	inch	mm	inch	mm	inch	
15	½	145	5.71	100.00	3.94	30.00	1.18	22.00	0.87	45	1.77	2	0.08	4
25	1	180	7.09	130.00	5.12	38.00	1.50	26.00	1.02	68	2.68	2	0.08	4
40	1½	220	8.66	165.00	6.50	48.00	1.89	30.00	1.18	88	3.46	3	0.12	4
50	2	235	9.25	180.00	7.09	52.00	2.05	30.00	1.18	102	4.02	3	0.12	8
65	2½	290	11.42	225.00	8.86	64.00	2.52	33.00	1.30	122	4.80	3	0.12	8
80	3	305	12.01	240.00	9.45	68.00	2.68	33.00	1.30	138	5.43	3	0.12	8
100	4	370	14.57	295.00	11.61	80.00	3.15	39.00	1.54	162	6.38	3	0.12	8
125	5	415	16.34	340.00	13.39	92.00	3.62	39.00	1.54	188	7.40	3	0.12	12
150	6	475	18.70	390.00	15.35	105.00	4.13	42.00	1.65	218	8.58	3	0.12	12
200	8	585	23.03	490.00	19.29	130.00	5.12	48.00	1.89	285	11.22	3	0.12	16

