

## ASME B16.5 | Class 150

ØID		ØOD		ØPCD		Tf		Ød		ØRF		RFt		Number of holes
DN	NPS	mm	inch	mm	inch	mm	inch	mm	inch	mm	inch	mm	inch	
15	½	90	3.50	60.3	2.38	8.0	0.31	15.88	¾	35.0	1.38	2	0.06	4
20	¾	100	3.88	69.9	2.75	8.9	0.34	15.88	¾	43.0	1.69	2	0.06	4
25	1	110	4.25	79.4	3.12	9.6	0.38	15.88	¾	51.0	2.00	2	0.06	4
32	1¼	115	4.62	88.9	3.50	11.2	0.44	15.88	¾	63.5	2.50	2	0.06	4
40	1½	125	5.00	98.4	3.88	12.7	0.50	15.88	¾	73.0	2.88	2	0.06	4
50	2	150	6.00	120.7	4.75	14.3	0.56	19.00	¾	92.0	3.62	2	0.06	4
65	2½	180	7.00	139.7	5.50	15.9	0.62	19.00	¾	105.0	4.12	2	0.06	4
80	3	190	7.50	152.4	6.00	17.5	0.69	19.00	¾	127.0	5.00	2	0.06	4
100	4	230	9.00	190.5	7.50	22.3	0.88	19.00	¾	157.0	6.19	2	0.06	8
125	5	255	10.00	215.9	8.50	22.3	0.88	22.50	7/8	186.0	7.31	2	0.06	8
150	6	280	11.00	241.3	9.50	23.9	0.94	22.50	7/8	216.0	8.50	2	0.06	8
200	8	345	13.50	298.5	11.75	27.0	1.06	22.50	7/8	270.0	10.62	2	0.06	8
250	10	405	16.00	362.0	14.25	28.6	1.12	25.50	7/8	324.0	12.75	2	0.06	12
300	12	485	19.00	431.8	17.00	30.2	1.19	25.50	1	381.0	15.00	2	0.06	12
350	14	535	21.00	476.3	18.75	33.4	1.31	28.50	1½	413.0	16.25	2	0.06	12
400	16	595	23.50	539.8	21.25	35.0	1.38	28.50	1½	470.0	18.50	2	0.06	16
450	18	635	25.00	577.9	22.75	38.1	1.50	31.75	1¼	533.0	21.00	2	0.06	16
500	20	700	27.50	635.0	25.00	41.3	1.62	31.75	1¼	584.0	23.00	2	0.06	20
550	22	750	29.50	692.2	27.25	44.5	1.75	35.00	1¾	641.5	25.25	2	0.06	20
600	24	815	32.00	749.3	29.50	46.1	1.81	35.00	1¾	692.0	27.25	2	0.06	20

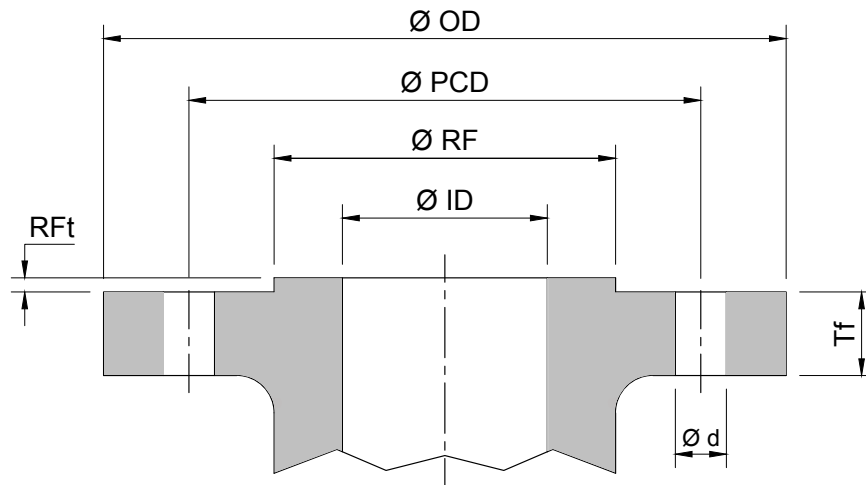

## ASME B16.5 | Class 300

ØID		ØOD		ØPCD		Tf		Ød		ØRF		Rf		Number of holes
DN	NPS	mm	inch	mm	inch	mm	inch	mm	inch	mm	inch	mm	inch	
15	½	95	3.75	66.7	2.62	12.7	0.50	15.88	¾	35.0	1.38	2	0.06	4
20	¾	115	4.62	82.6	3.25	14.3	0.56	19.00	¾	43.0	1.69	2	0.06	4
25	1	125	4.88	88.9	3.50	15.9	0.62	19.00	¾	51.0	2.00	2	0.06	4
32	1¼	135	5.25	98.4	3.88	17.5	0.69	19.00	¾	63.5	2.50	2	0.06	4
40	1½	155	6.12	114.3	4.50	19.1	0.75	22.50	7/8	73.0	2.88	2	0.06	4
50	2	165	6.50	127.0	5.00	20.7	0.81	19.00	¾	92.0	3.62	2	0.06	8
65	2½	190	7.50	149.2	5.88	23.9	0.94	22.50	7/8	105.0	4.12	2	0.06	8
80	3	210	8.25	168.3	6.62	27.0	1.06	22.50	7/8	127.0	5.00	2	0.06	8
100	4	255	10.00	200.0	7.88	30.2	1.19	22.50	7/8	157.0	6.19	2	0.06	8
125	5	280	11.00	235.0	9.25	33.4	1.31	22.50	7/8	186.0	7.31	2	0.06	8
150	6	320	12.50	269.9	10.62	35.0	1.38	22.50	7/8	216.0	8.50	2	0.06	12
200	8	380	15.00	330.2	13.00	39.7	1.56	25.50	1	270.0	10.62	2	0.06	12
250	10	445	17.50	387.4	15.25	46.1	1.81	28.50	1½	324.0	12.75	2	0.06	16
300	12	520	20.50	450.8	17.75	49.3	1.94	31.75	1¼	381.0	15.00	2	0.06	16
350	14	585	23.00	514.4	20.25	52.4	2.06	31.75	1¼	413.0	16.25	2	0.06	20
400	16	650	25.50	571.5	22.50	55.6	2.19	35.00	1¾	470.0	18.50	2	0.06	20
450	18	710	28.00	628.6	24.75	58.8	2.31	35.00	1¾	533.0	21.00	2	0.06	24
500	20	775	30.50	685.8	27.00	62.0	2.44	35.00	1¾	584.0	23.00	2	0.06	24
550	22	840	33.00	743.0	29.25	65.1	2.56	41.50	1¾	641.5	25.25	2	0.06	24
600	24	915	36.00	812.8	32.00	68.3	2.69	41.50	1¾	692.0	27.25	2	0.06	24



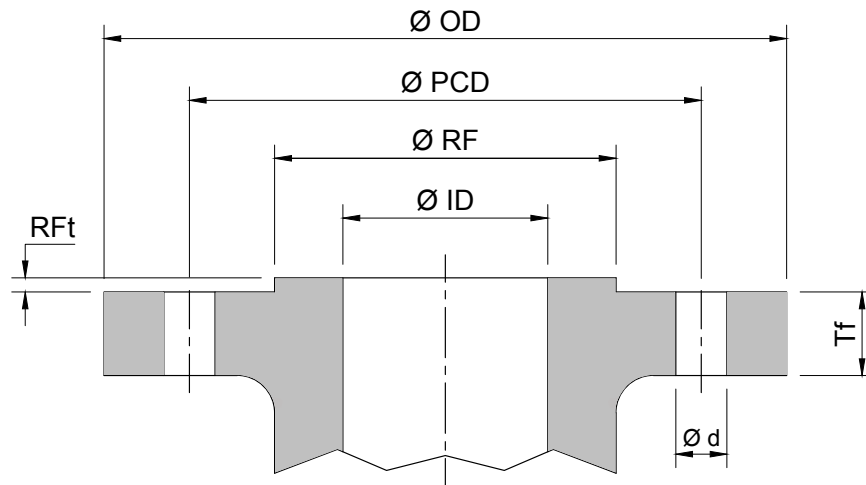

## ASME B16.5 | Class 600

ØID		ØOD		ØPCD		Tf		Ød		ØRF		Rf		Number of holes
DN	NPS	mm	inch	mm	inch	mm	inch	mm	inch	mm	inch	mm	inch	
15	½	95	3.75	66.7	2.62	14.3	0.56	15.88	⅝	35.0	1.38	7	0.25	4
20	¾	115	4.62	82.6	3.25	15.9	0.62	19.00	¾	43.0	1.69	7	0.25	4
25	1	125	4.88	88.9	3.50	17.5	0.69	19.00	¾	51.0	2.00	7	0.25	4
32	1¼	135	5.25	98.4	3.88	20.7	0.81	19.00	¾	63.5	2.50	7	0.25	4
40	1½	155	6.12	114.3	4.50	22.3	0.88	22.50	⅞	73.0	2.88	7	0.25	4
50	2	165	6.50	127.0	5.00	25.4	1.00	19.00	¾	92.0	3.62	7	0.25	8
65	2½	190	7.50	149.2	5.88	28.6	1.12	22.50	⅞	105.0	4.12	7	0.25	8
80	3	210	8.25	168.3	6.62	31.8	1.25	22.50	⅞	127.0	5.00	7	0.25	8
100	4	275	10.75	215.9	8.50	38.1	1.50	25.50	1	157.0	6.19	7	0.25	8
125	5	330	13.00	266.7	10.50	44.5	1.75	28.50	1⅛	186.0	7.31	7	0.25	8
150	6	355	14.00	292.1	11.50	47.7	1.88	28.50	1⅛	216.0	8.50	7	0.25	12
200	8	420	16.50	349.2	13.75	55.6	2.19	31.75	1¼	270.0	10.62	7	0.25	12
250	10	510	20.00	431.8	17.00	63.5	2.50	35.00	1⅜	324.0	12.75	7	0.25	16
300	12	560	22.00	489.0	19.25	66.7	2.62	35.00	1⅜	381.0	15.00	7	0.25	20
350	14	605	23.75	527.0	20.75	69.9	2.75	38.00	1½	413.0	16.25	7	0.25	20
400	16	685	27.00	603.2	23.75	76.2	3.00	41.50	1⅝	470.0	18.50	7	0.25	20
450	18	745	29.25	654.0	25.75	82.6	3.25	45.00	1¾	533.0	21.00	7	0.25	20
500	20	815	32.00	723.9	28.50	88.9	3.50	45.00	1¾	584.0	23.00	7	0.25	24
550	22	870	34.25	777.7	30.62	95.2	3.75	48.00	1⅞	641.5	25.25	7	0.25	24
600	24	940	37.00	838.2	33.00	101.6	4.00	51.00	2	692.0	27.25	7	0.25	24

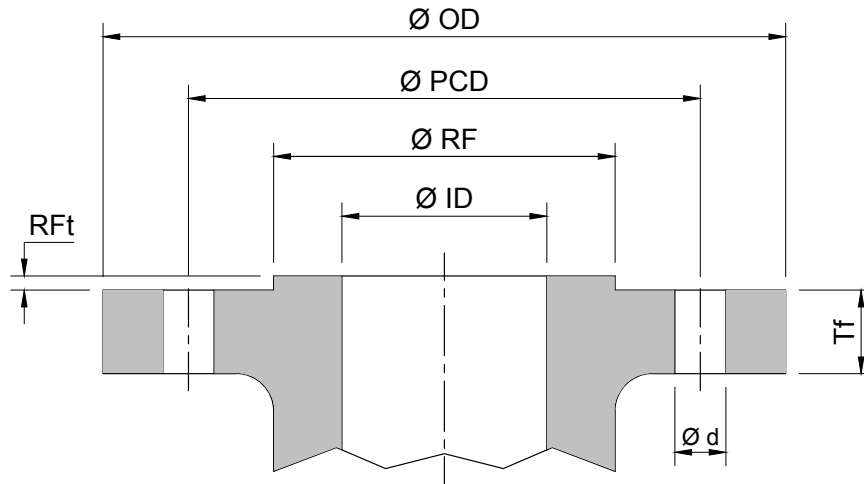

## ASME B16.5 | Class 900

ØID		ØOD		ØPCD		Tf		Ød		ØRF		Rf		Number of holes
DN	NPS	mm	inch	mm	inch	mm	inch	mm	inch	mm	inch	mm	inch	
15	½	120	4.75	82.6	3.25	22.3	0.88	22.50	¾	35.0	1.38	7	0.25	4
20	¾	130	5.12	88.9	3.50	25.4	1.00	22.50	¾	43.0	1.69	7	0.25	4
25	1	150	5.88	101.6	4.00	28.6	1.12	25.50	1	51.0	2.00	7	0.25	4
32	1¼	160	6.25	111.1	4.38	28.6	1.12	25.50	1	63.5	2.50	7	0.25	4
40	1½	180	7.00	123.8	4.88	31.8	1.25	28.50	1 ⅛	73.0	2.88	7	0.25	4
50	2	215	8.50	165.1	6.50	38.1	1.50	25.50	1	92.0	3.62	7	0.25	8
65	2½	245	9.62	190.5	7.50	41.3	1.62	28.50	1 ⅛	105.0	4.12	7	0.25	8
80	3	240	9.50	190.5	7.50	38.1	1.50	25.50	1	127.0	5.00	7	0.25	8
100	4	290	11.50	235.0	9.25	44.5	1.75	31.75	1 ¼	157.0	6.19	7	0.25	8
125	5	350	13.75	279.4	11.00	50.8	2.00	35.00	1 ⅜	186.0	7.31	7	0.25	8
150	6	380	15.00	317.5	12.50	55.6	2.19	31.75	1 ¼	216.0	8.50	7	0.25	12
200	8	470	18.50	393.7	15.50	63.5	2.50	38.00	1 ½	270.0	10.62	7	0.25	12
250	10	545	21.50	469.9	18.50	69.9	2.75	38.00	1 ½	324.0	12.75	7	0.25	16
300	12	610	24.00	533.4	21.00	79.4	3.12	38.00	1 ½	381.0	15.00	7	0.25	20
350	14	640	25.25	558.8	22.00	85.8	3.38	41.50	1 ⅝	413.0	16.25	7	0.25	20
400	16	705	27.75	616.0	24.25	88.9	3.50	44.50	1 ¾	470.0	18.50	7	0.25	20
450	18	785	31.00	685.8	27.00	101.6	4.00	51.00	2	533.0	21.00	7	0.25	20
500	20	855	33.75	749.3	29.50	108.0	4.25	54.00	2 ⅛	584.0	23.00	7	0.25	20
600	24	1040	41.00	901.7	35.50	139.7	5.50	66.50	2 ⅝	692.0	27.25	7	0.25	20



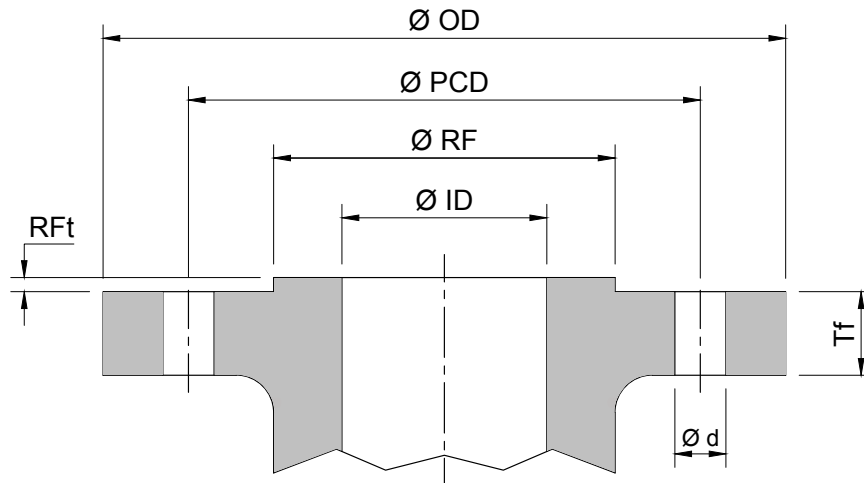

## ASME B16.5 | Class 1500

ØID		ØOD		ØPCD		Tf		Ød		ØRF		Rf		Number of holes
DN	NPS	mm	inch	mm	inch	mm	inch	mm	inch	mm	inch	mm	inch	
15	½	120	4.75	82.6	3.25	22.3	0.88	22.50	⅞	35.0	1.38	7	0.25	4
20	¾	130	5.12	88.9	3.50	25.4	1.00	22.50	⅞	43.0	1.69	7	0.25	4
25	1	150	5.88	101.6	4.00	28.6	1.12	25.50	1	51.0	2.00	7	0.25	4
32	1¼	160	6.25	111.1	4.38	28.6	1.12	25.50	1	63.5	2.50	7	0.25	4
40	1½	180	7.00	123.8	4.88	31.8	1.25	28.50	1⅛	73.0	2.88	7	0.25	4
50	2	215	8.50	165.1	6.50	38.1	1.50	25.50	1	92.0	3.62	7	0.25	8
65	2½	245	9.62	190.5	7.50	41.3	1.62	28.50	1⅛	105.0	4.12	7	0.25	8
80	3	265	10.50	203.2	8.00	47.7	1.88	31.75	1¼	127.0	5.00	7	0.25	8
100	4	310	12.25	241.3	9.50	54.0	2.12	35.00	1⅜	157.0	6.19	7	0.25	8
125	5	375	14.75	292.1	11.50	73.1	2.88	41.50	1⅝	186.0	7.31	7	0.25	8
150	6	395	15.50	317.5	12.50	82.6	3.25	38.00	1½	216.0	8.50	7	0.25	12
200	8	485	19.00	393.7	15.50	92.1	3.62	45.00	1¾	270.0	10.62	7	0.25	12
250	10	585	23.00	482.6	19.00	108.0	4.25	51.00	2	324.0	12.75	7	0.25	12
300	12	675	26.50	571.5	22.50	123.9	4.88	54.00	2⅛	381.0	15.00	7	0.25	16
350	14	750	29.50	635.0	25.00	133.4	5.25	60.50	2⅜	413.0	16.25	7	0.25	16
400	16	825	32.50	704.8	27.75	146.1	5.75	66.50	2⅝	470.0	18.50	7	0.25	16
450	18	915	36.00	774.7	30.50	162.0	6.38	73.50	2⅞	533.0	21.00	7	0.25	16
500	20	985	38.75	831.8	32.75	177.8	7.00	80.00	2⅞	584.0	23.00	7	0.25	16
600	24	1170	46.00	990.6	39.00	203.2	8.00	92.00	3⅛	692.0	27.25	7	0.25	16
600	24	915	36.00	812.8	32.00	68.3	2.69	41.50	3⅝	692.0	27.25	7	0.06	

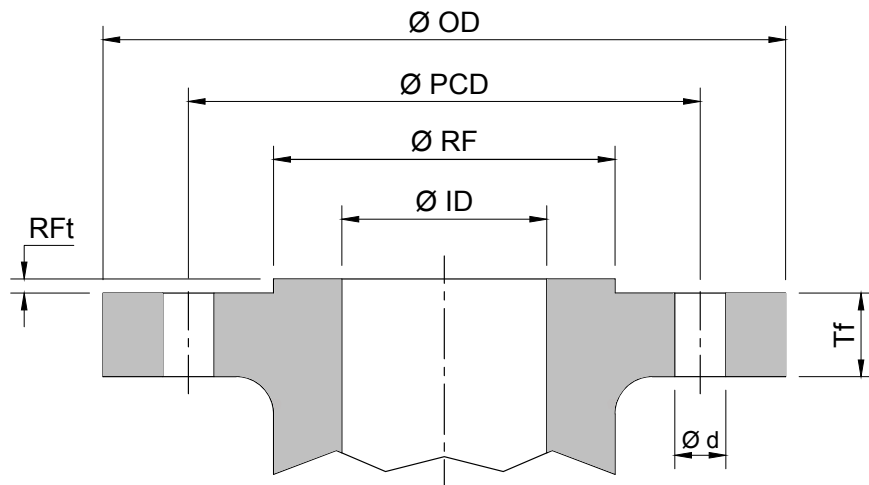

## ASME B16.5 | Class 2500

ØID		ØOD		ØPCD		Tf		Ød		ØRF		Rf		Number of holes
DN	NPS	mm	inch	mm	inch	mm	inch	mm	inch	mm	inch	mm	inch	
15	½	135	5.25	88.9	3.50	30.2	1.19	22.50	7/8	35.0	1.38	7	0.25	4
20	¾	140	5.50	95.2	3.75	31.8	1.25	22.50	7/8	43.0	1.69	7	0.25	4
25	1	160	6.25	108.0	4.25	35.0	1.38	25.50	1	51.0	2.00	7	0.25	4
32	1¼	185	7.25	130.2	5.12	38.1	1.50	28.50	1 1/8	63.5	2.50	7	0.25	4
40	1½	205	8.00	146.0	5.75	44.5	1.75	31.75	1 ¼	73.0	2.88	7	0.25	4
50	2	235	9.25	171.4	6.75	50.9	2.00	28.50	1 ½	92.0	3.62	7	0.25	8
65	2½	265	10.50	196.8	7.75	57.2	2.25	31.75	1 ¾	105.0	4.12	7	0.25	8
80	3	305	12.00	228.6	9.00	66.7	2.62	35.00	1 ¾	127.0	5.00	7	0.25	8
100	4	355	14.00	273.0	10.75	76.2	3.00	41.50	1 5/8	157.0	6.19	7	0.25	8
125	5	420	16.50	323.8	12.75	92.1	3.62	48.00	1 7/8	186.0	7.31	7	0.25	8
150	6	485	19.00	368.3	14.50	108.0	4.25	54.00	2 1/8	216.0	8.50	7	0.25	8
200	8	550	21.75	438.2	17.25	127.0	5.00	54.00	2 1/8	270.0	10.62	7	0.25	12
250	10	675	26.50	539.8	21.25	165.1	6.50	66.50	2 5/8	324.0	12.75	7	0.25	12
300	12	760	30.00	619.1	24.38	184.2	7.25	73.50	2 7/8	381.0	15.00	7	0.25	12

